

LOCATION PLAN OF THE G+FOUR STORIED RESIDENTIAL BUILDING AT PREMISES NO. 2266, NAYABAD, J.L. NO. 25, R.S. DAG NO. 132(P), KHATIAN NO. 101, WARD NO.109, BOROUGH-XII. POLICE STATION-PANCHASAYAR. KOLKATA-700099.

Permissible height in reference to CCZM issued by AAI: 33.00 m.  
Co-ordinate in WGS 84 and site elevation(AMSL):

Reference point marked in the site plan of the proposal	Co-ordinate in WGS84		Site elevation(AMSL)
	Latitude	Longitude	
A-FRONT (AS MARKED IN SITE PLAN)	22.487499	88.411511	3.9 M.
B-SIDE (AS MARKED IN SITE PLAN)	22.487499	88.411511	3.9 M.

The above information is true and correct in all respect and if at any stage, it is found otherwise, then I shall be fully liable for which KMC and other

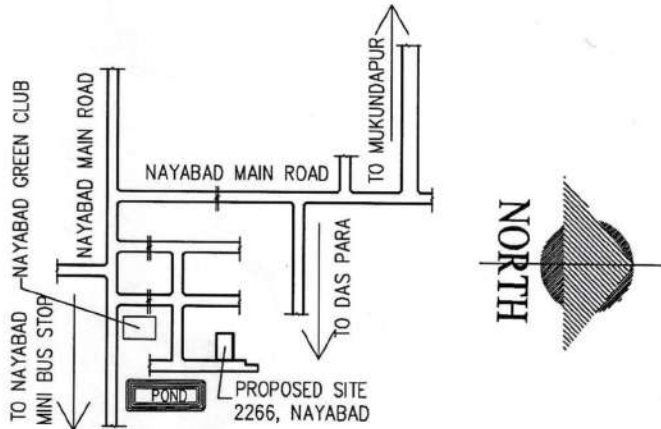
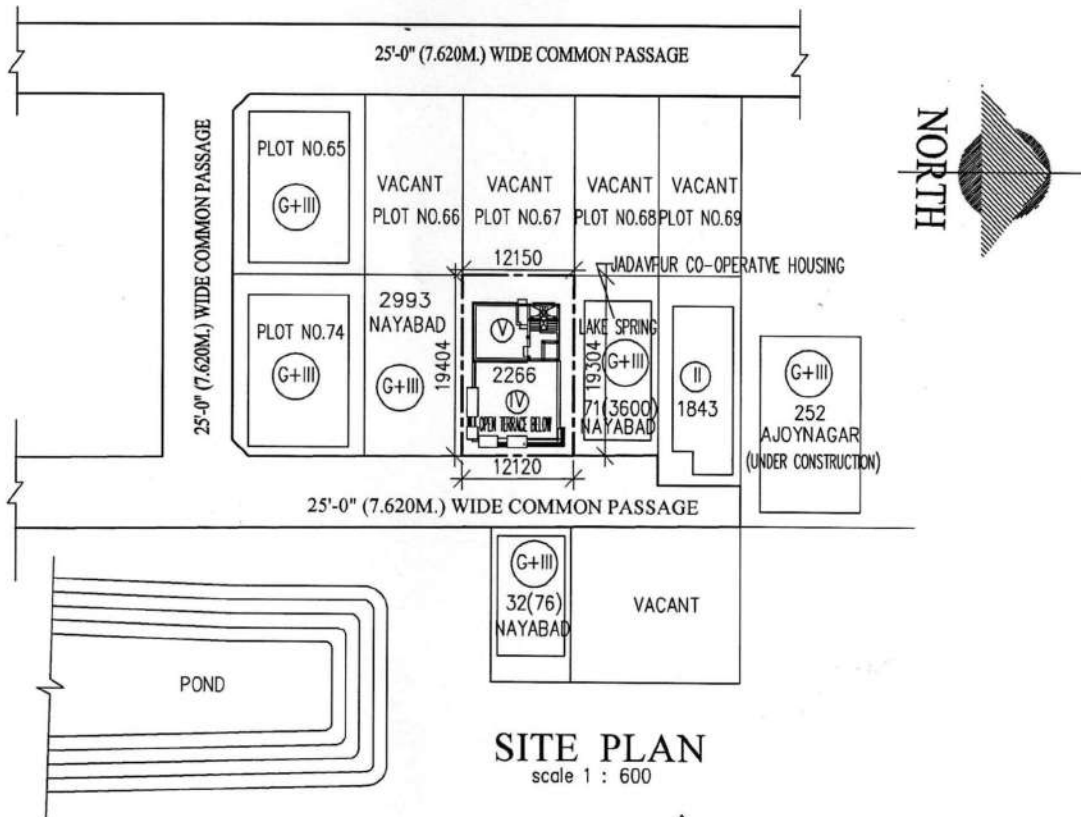

For GHARBARI DEVELOPERS

*Anju Roy*  
Proprietor

**Proprietor**

*Sanjoy Kumar Poddar*  
**SANJOY KUMAR PODDAR**  
Registered Architect  
CA / 88 / 11483